

**FOR SUB
LEASE**

**1000 Access Blvd.,
Madison, IL 62060**



75,000 - 154,800 SF WAREHOUSE SPACE

BARBERMURPHY

COMMERCIAL REAL ESTATE SOLUTIONS
1173 Fortune Blvd., Shiloh, IL 62269
618.277.4400 BARBERMURPHY.COM

Steve Zuber - CCIM, SIOR
Principal
Cell: (314) 409-7283
steve@barbermurphy.com

Wayne Barber Jr. - SIOR
Principal
Cell: (618) 593-4000
wayne@barbermurphy.com



AREA MAP / PROPERTY PHOTOS

1000 Access Blvd., Madison, IL 62060



22
DOCK DOORS

30'
CLEAR HEIGHT

DRY
SPRINKLER SYSTEM

I-64 & I-70

PROPERTY SUMMARY

- 75,000-154,800 SF for Sub-Lease
- 22 Dock Doors, 30' Height
- Dry Sprinkler System
- Food Grade

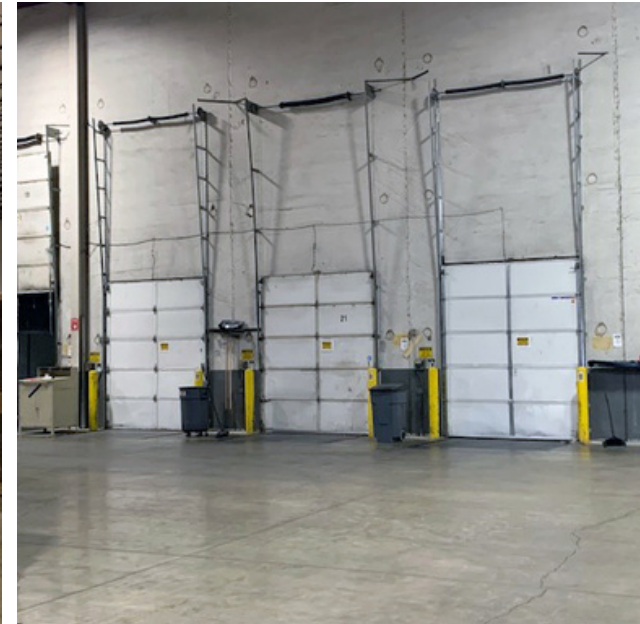

INDUSTRIAL PROPERTY SUMMARY

1000 ACCESS BLVD

LISTING # 0.70

LOCATION DETAILS:

Parcel #: 21-1-19-26-00-000-001.002
County: IL - Madison
Zoning: Industrial - City of Madison

PROPERTY OVERVIEW:

Building SF: 154,800
Office SF: 4,800
Warehouse SF: 150,000
Min Divisible SF: 15,000
Max Contig SF: 154,800
Lot Size: 6.43 Acres
Frontage: 586
Depth: 480
Parking Spaces: 50
Parking Surface Type: Concrete
Archeological: No
Environmental: No
Survey: No

STRUCTURAL DATA:

Year Built: 1989
Clear Ht Min: 30'
Clear Ht Max: 30'
Bay Spacing: 50'x50'
Construction Type: Concrete Tilt Up, Concrete
Roof: Flat/Membrane
Floor Type: Reinforced Concrete
Floor Thickness: 6"

FACILITY INFORMATION:

Heat: Warehouse
AC: Office
Lighting: LED
Sprinklers: Dry System
Insulated: Yes
Ventilation: Yes
Compressed Air: No
Restrooms Men: Yes
Restrooms Womens: Yes
Showers: No
Floor Drains: No

LOADING & DOORS:

of Dock Doors: 22
Dock Door Size: 10'x8'
Dock Levelers: Yes
Drive In Doors: 1
Drive In Door Size: 12'x12'

TRANSPORATION:

Interstate Access: 2.5 Miles to I-70 & 1/2 Mile to IL Rte 3
Airport Access: Lambert International - 12 Miles
Rail Access: Adjacent
Rail Line: Terminal Rail
Rail Status: Near by



COMMERCIAL REAL ESTATE SOLUTIONS
1173 Fortune Boulevard Shiloh, IL 62269
618-277-4400 BARBERMURPHY.COM

STEVE ZUBER, CCIM, SIOR

Principal
O: (618) 277-4400
C: 618-277-4400 x 13
steve@barbermurphy.com

INDUSTRIAL PROPERTY SUMMARY PG 2

1000 ACCESS BLVD

UTILITY INFO:

Water Provider:	IL American
Water Location:	On Site
Sewer Provider:	Metro East Sanitary
Sewer Location:	On Site
Gas Provider:	Ameren IL
Gas Location:	On Site
Electric Provider:	Ameren IL
Electric Location:	On Site
Voltage Low:	120
Voltage High:	480
Amps:	400
Phase:	3

TAX INCENTIVE ZONES:

TIF District:	No
Enterprise Zone:	Yes
Opportunity Zone:	Yes
Foreign Trade Zone:	No

FINANCIAL INFORMATION:

Taxes:	\$134,102.00
Tax Year:	2023

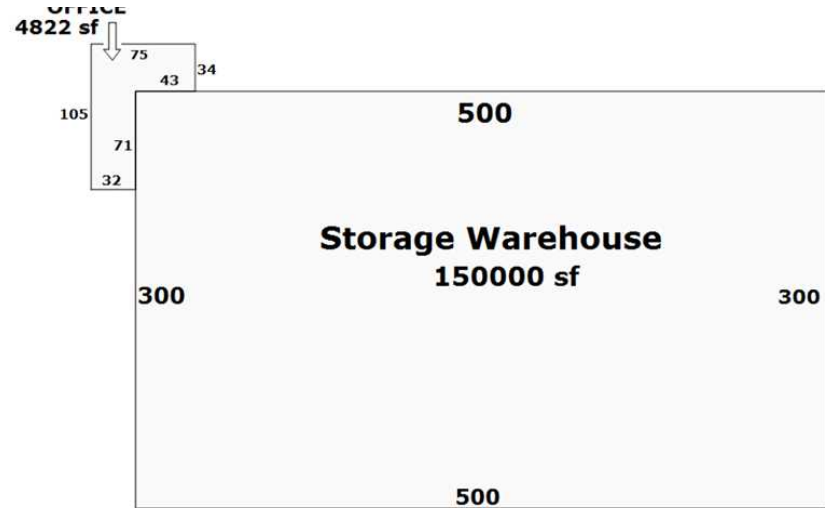

LEASE INFORMATION:

Lease Rate:	\$4.50 / SF
Lease Type:	NNN
NNN Expenses:	\$1.25

PROPERTY DESCRIPTION:

Tenant will Sublease 75,000-154,800 through October 2029
Warehouse is 300' x 500' with 22 truck docks, 30' clear height and 50'x50' column spacing
4,800 SF of office
Dry Sprinkler System
Food Grade

BARBERMURPHY

COMMERCIAL REAL ESTATE SOLUTIONS
1173 Fortune Boulevard Shiloh, IL 62269
618-277-4400 BARBERMURPHY.COM

STEVE ZUBER, CCIM, SIOR

Principal
O: (618) 277-4400
C: 618-277-4400 x 13
steve@barbermurphy.com