

## Villages at Wingate - Mixed Use Development

North Green Mount Rd, Shiloh, Illinois 62221  
St. Clair County

**Collin Fischer - SIOR, CCIM**

Phone: 618-420-2376

Email: collinf@barbermurphy.com

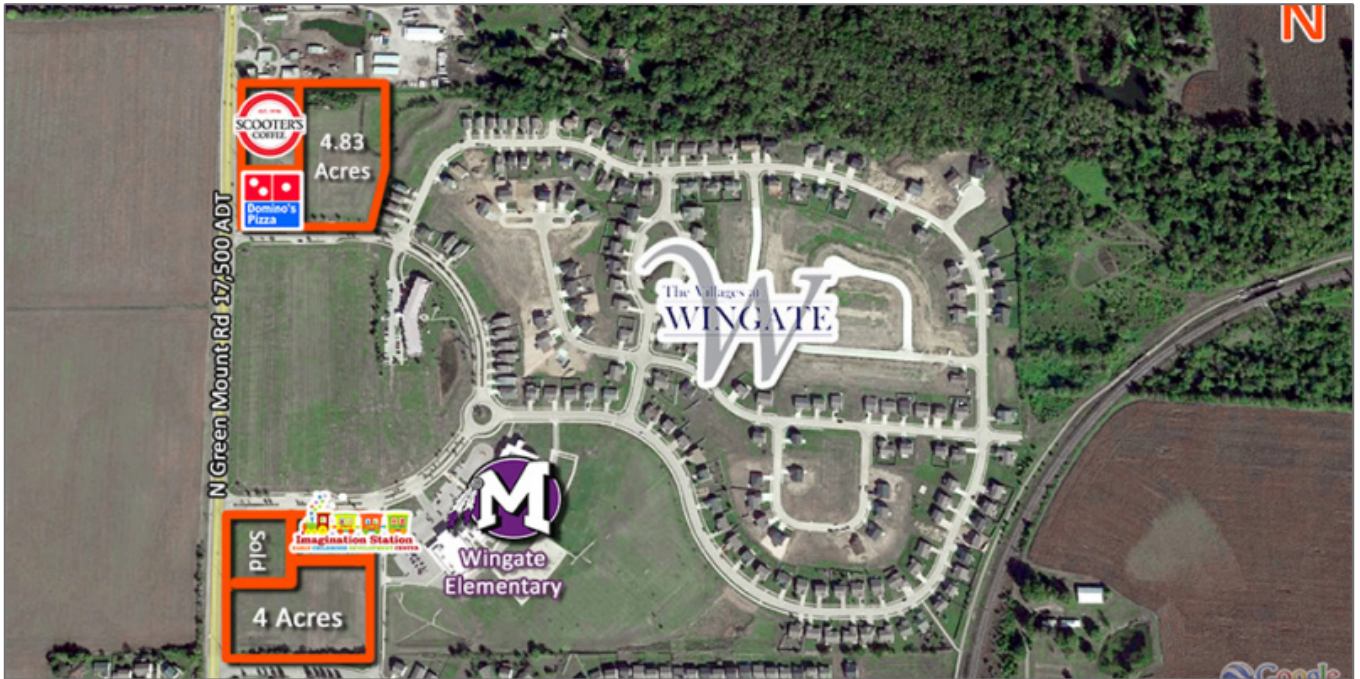

### Basic Details

Listing No:	600
Sale Or Lease:	For Sale
Property Type(s):	Land, Land - Commercial, Land - Mixed Use
Min Acres Available:	4 Acre(s)
Max Acres Available:	8.87 Acre(s)
Sale Price:	Starting at \$1.19/SF

### Address

Country:	US
State:	IL
County:	St. Clair
City:	Shiloh
Zipcode:	62221
Street:	North Green Mount
Street Suffix:	Rd

### Property Information

Parcel No:	09-18.0-303-003; 09-18.0-301-008
Zoning:	PB
Zoning By:	Shiloh
Complex:	Villages at Wingate
Traffic Count:	17,500
Topography:	Flat

### Land Measurements

Total Acres Available:	8.87 Acre(s)
Min Divisible Acres:	4 Acre(s)

### Utility Information

Water Provider:	IL American
Water Provider:	On Site

### Transportation

Interstate:	I-64; Exit 16 (2.8 miles)
Rail:	No

Location:	
Sewer Provider:	Village of Shiloh
Sewer Provider Location:	On Site
Gas Provider:	Ameren IL
Gas Provider Location:	On Site
Electric Provider:	Ameren IL
Electric Provider Location:	On Site

Barge:	No
Airport:	MidAmerica St. Louis